

multiV+® 100							
External width : 136mm Internal width : 100mm Length (L) : 1000mm							
Channel reference:	Total height		Internal height		Hydraulic section (cm <sup>2</sup> )	Ø outlet(mm)	
	h (mm)	H (mm)	a (mm)	b (mm)		Vert.	Horiz.
R100G00R	100	100	62	62	56	110	-
R100G01	100	105	62	67	61	110	-
R100G02	105	110	67	72	64.5	110	-
R100G03	110	115	72	77	67.5	110	-
R100G04	115	120	77	82	71	110	-
R100G05	120	125	82	87	74.5	110	-
R100G06	125	130	87	92	78	110	-
R100G07	130	135	92	97	81.5	110	-
R100G08	135	140	97	102	84.5	110	-
R100G09	140	145	102	107	88	110	-
R100G10	145	150	107	112	91.5	110	-
R100G10R	150	150	112	112	91.5	110	-
R100G11	150	155	112	117	96.5	110	-
R100G12	155	160	117	122	100.5	110	-
R100G13	160	165	122	127	105	110	-
R100G14	165	170	127	132	109	110	-
R100G15	170	175	132	137	113	110	-
R100G16	175	180	137	142	117	110	-
R100G17	180	185	142	147	121	110	-
R100G18	185	190	147	152	125	110	-
R100G19	190	195	152	157	129	110	-
R100G20	195	200	157	162	133	110	-
R100G20R	200	200	162	162	133	110	-
R100G21	200	205	162	167	137.3	110	-
R100G22	205	210	167	172	141.6	110	-
R100G23	210	215	172	177	145.9	110	-
R100G24	215	220	177	182	150.2	110	-
R100G25	220	225	182	187	154.5	110	-
R100G26	225	230	187	192	158.8	110	-
R100G27	230	235	192	197	163.1	110	-
R100G28	235	240	197	202	167.4	110	-
R100G29	240	245	202	207	171.7	110	-
R100G30	245	250	207	212	176	110	-
R100G30R	250	250	212	212	176	110	-
R100G40R	300	300	262	262	220	110	-

Review: 2017-05

### Description

ULMA polymer concrete linear drainage channel model MultiV+® R100G. Self-cleaning optimized V-shaped V+ section.

Protective galvanized steel edge with a real thickness of 2+2 mm, smooth, without breakage of the protective zinc layer, avoiding water accumulation and preventing corrosion.

Boltless locking system ULMA Rapidlock®, 8 fixing points per lm for higher mechanical stability.

Load class up to D400, EN 1433 Standard.

Grooved to ease joint sealing and vertically and horizontally channel aligning tongue and groove.

CE Conformity Declaration and compliance with EN 1433 Standard.

External width 136mm, internal width 100mm and total length 1000mm. Total heights available between 100mm and 300mm. Installation possible with no slope, 0.5% presloped, stepped fall or mixed slope.

ULMA Architectural Solutions reserves the right to modify the specifications of any of its products without prior notice.

Information about the shown products is only indicative and is based on the existing technical features at the time of issuing.

In the event of any discrepancy in the translation of this document into different languages, the Spanish version will be used.

Latest version in [www.ulmaarchitectural.com](http://www.ulmaarchitectural.com)

For more details, see technical sheets and installation guide.



ARCHITECTURAL SOLUTIONS



Tel.: +34 943 78 06 00  
info@ulmaarchitectural.com  
[ulmaarchitectural.com](http://ulmaarchitectural.com)

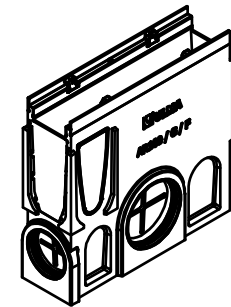
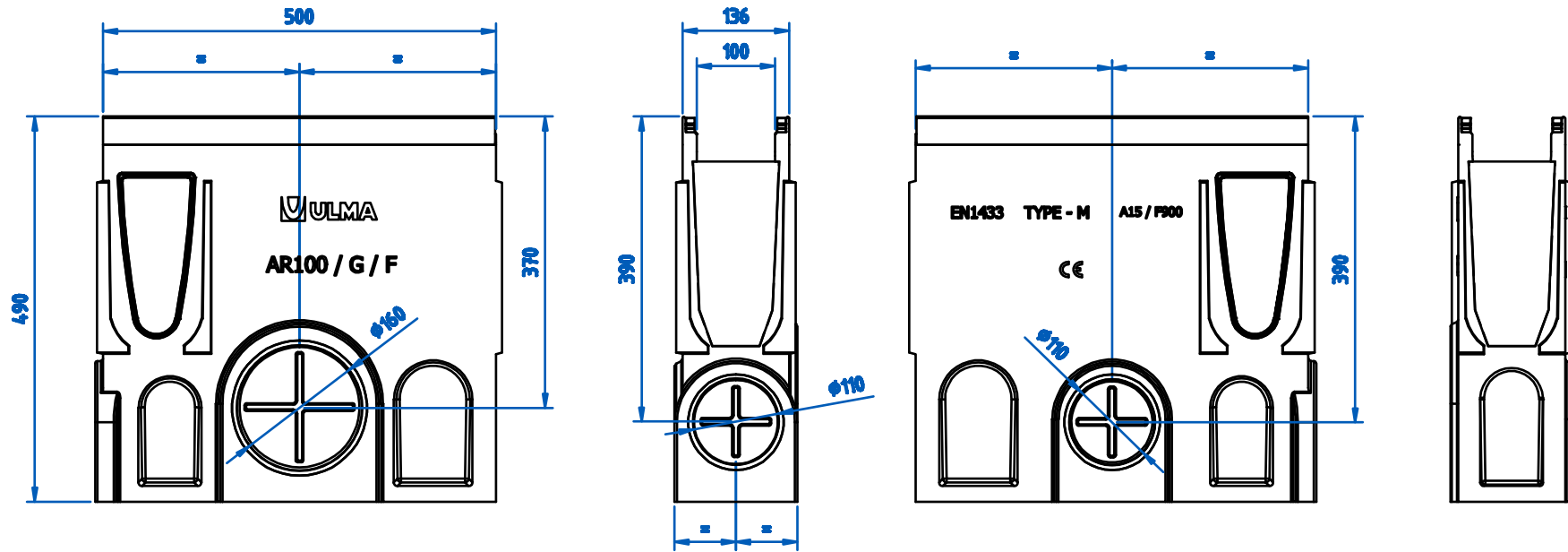

**Review: 2013-04**

ULMA Architectural Solutions reserves the right to modify the specifications of any of its products without prior notice.

Information about the shown products is only indicative and is based on the existing technical features at the time of issuing.

In the event of any discrepancy in the translation of this document into different languages, the Spanish version will be used.

Latest version in [www.ulmaarchitectural.com](http://www.ulmaarchitectural.com)

For more details, see technical sheets and installation guide.

**Description**

ULMA multIV+ Polymer concrete linear drainage sump unit model AR100G. Compatible with self-cleaning optimized V-shaped V+ section channels. Protective galvanized steel edge with a real thickness of 2+2 mm, smooth, without breakage of the protective zinc layer, avoiding water accumulation and preventing corrosion. Boltless locking system ULMA Rapidlock®, 8 fixing points per lm. Load class up to D400, EN 1433 Standard. Vertically and horizontally aligning tongue and groove joints. CE Conformity Declaration and compliance with EN 1433 Standard. Total height 490 mm, internal width 100mm, total width 136mm and total length 500mm.  $\varnothing$ 110mm and  $\varnothing$ 160mm preformed knockouts with triple lipped seals for water tight connection. CR100 bucket compatible.



**ARCHITECTURAL SOLUTIONS**



Tel.: +34 943 78 06 00  
[info@ulmaarchitectural.com](mailto:info@ulmaarchitectural.com)  
[ulmaarchitectural.com](http://ulmaarchitectural.com)

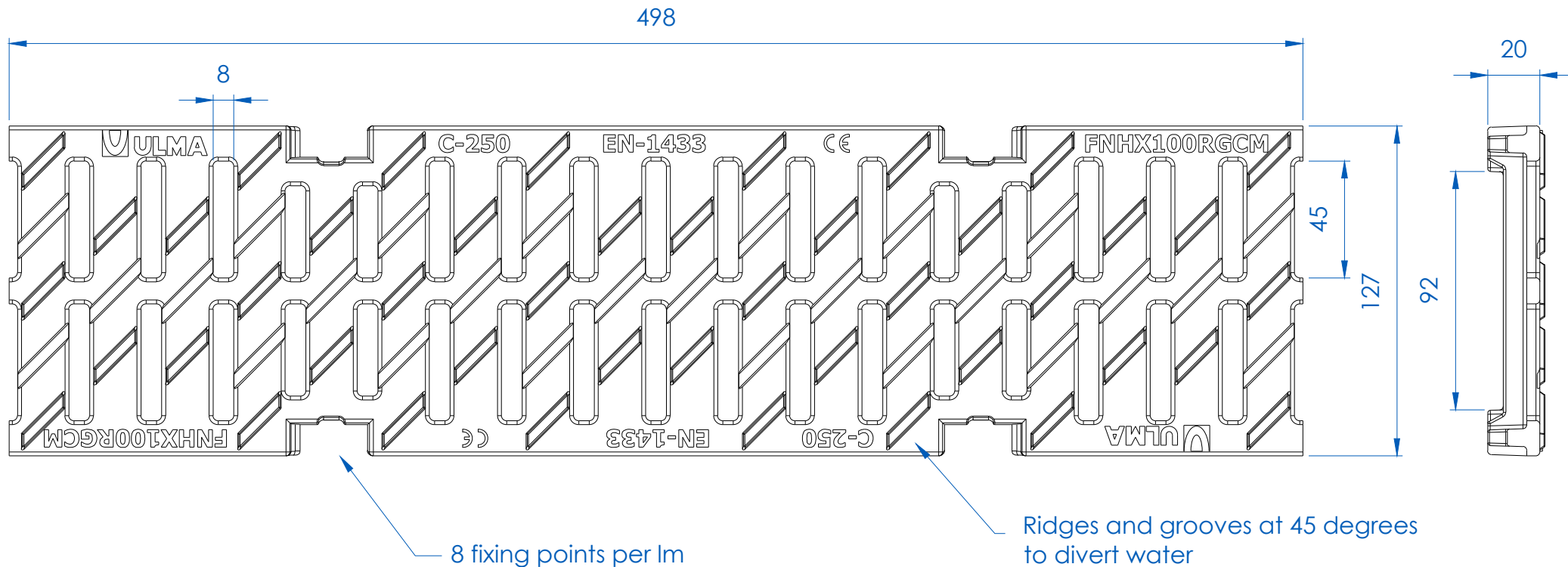

Review: 2020-01

ULMA Architectural Solutions reserves the right to modify the specifications of any of its products without prior notice.

Information about the shown products is only indicative and is based on the existing technical features at the time of issuing.

In the event of any discrepancy in the translation of this document into different languages, the Spanish version will be used.

Latest version in [www.ulmaarchitectural.com](http://www.ulmaarchitectural.com)

For more details, see technical sheets and installation guide.

### Description

Non-slip slotted grating reference FNHX100RGCM.  
 Casted espheroidal graphite ductile iron, EN 1563 Standard.  
 Load class C250, EN 1433 Standard.  
 Boltless locking system, 8 locking points per lm.  
 Bolt-locking system alternative.  
 Ridges and grooves at 45 degrees to divert water.  
 Walking stick and heel-safe slots.  
 Water catching surface: 247,04 cm<sup>2</sup>/lm.

 **ULMA**

ARCHITECTURAL SOLUTIONS

 DRAINAGE SYSTEMS

Tel.: +34 943 78 06 00  
 info@ulmaarchitectural.com  
[ulmaarchitectural.com](http://ulmaarchitectural.com)

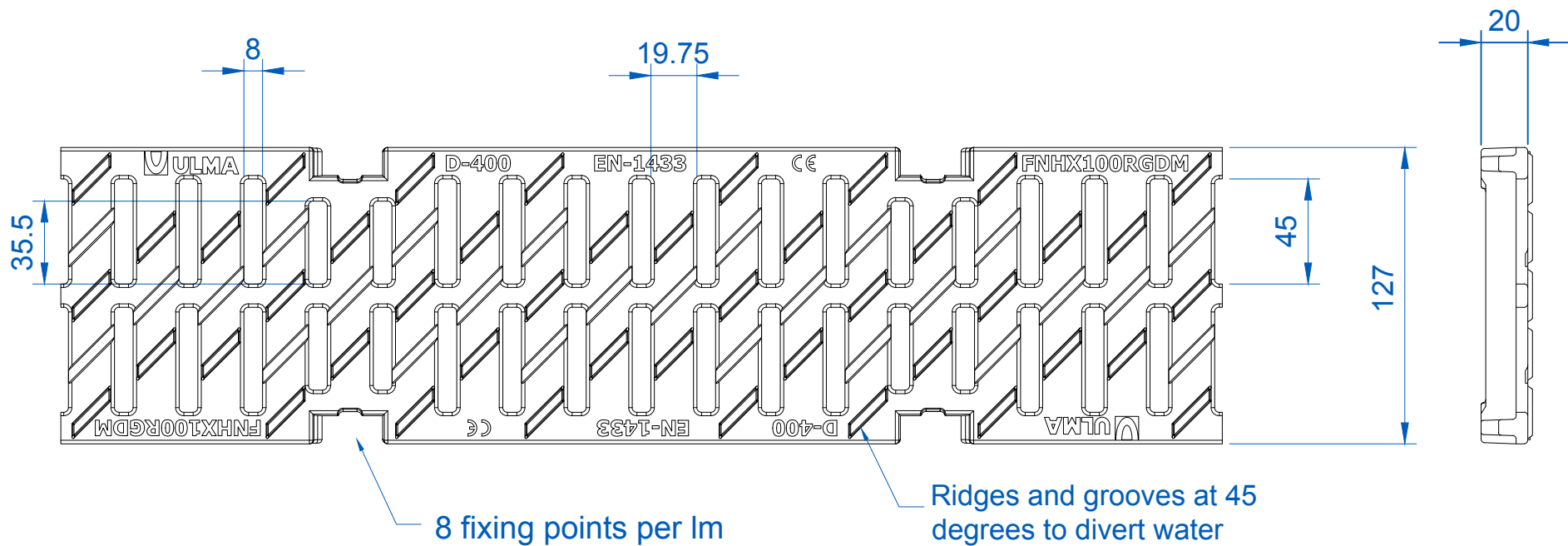

Review: 2016-03

ULMA Architectural Solutions reserves the right to modify the specifications of any of its products without prior notice.

Information about the shown products is only indicative and is based on the existing technical features at the time of issuing.

In the event of any discrepancy in the translation of this document into different languages, the Spanish version will be used.

Latest version in [www.ulmaarchitectural.com](http://www.ulmaarchitectural.com)

For more details, see technical sheets and installation guide.

### Description

Non-slip slotted grating reference FNHX100RGDM.  
 Casted espheroidal graphite ductile iron, EN 1563 Standard.  
 Load class D400, EN 1433 Standard.  
 Boltless locking system, 8 locking points per lm.  
 Bolt-locking system alternative.  
 Ridges and grooves at 45 degrees to divert water.  
 Walking stick and heel-safe slots.  
 Water catching surface: 263 cm<sup>2</sup>/lm.



ARCHITECTURAL SOLUTIONS



Tel.: +34 943 78 06 00  
 info@ulmaarchitectural.com  
 ulmaarchitectural.com

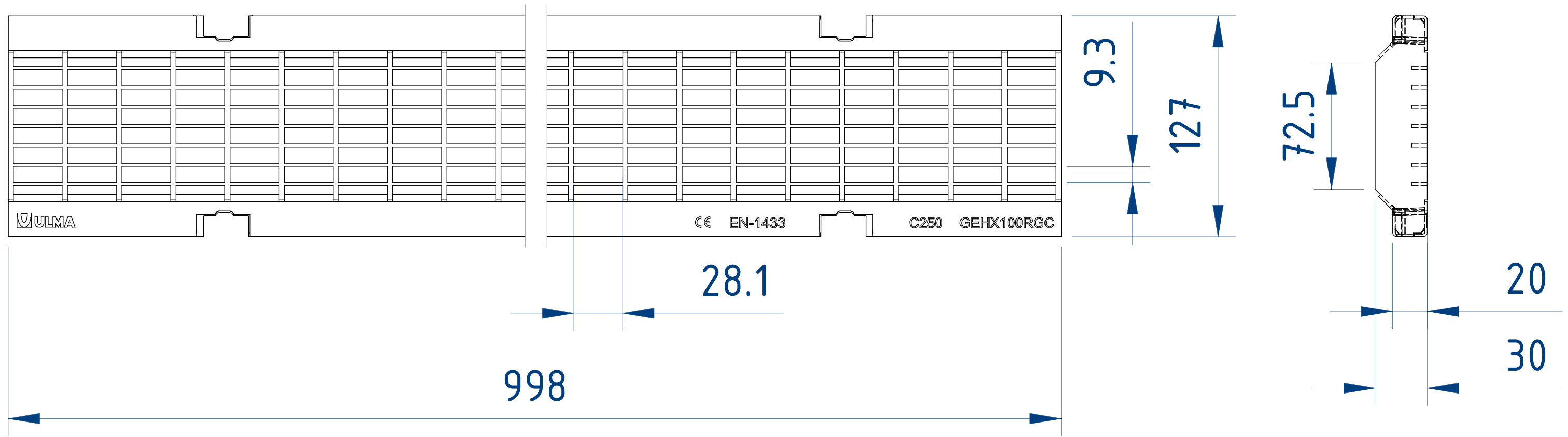

Review: 2014-12

ULMA Architectural Solutions reserves the right to modify the specifications of any of its products without prior notice.

Information about the shown products is only indicative and is based on the existing technical features at the time of issuing.

In the event of any discrepancy in the translation of this document into different languages, the Spanish version will be used.

Latest version in [www.ulmaarchitectural.com](http://www.ulmaarchitectural.com)

For more details, see technical sheets and installation guide.

**Description**

Non-slip mesh grating reference GEHX100RGC.  
 Hot-dip galvanized steel, EN ISO 1461 Standard.  
 Load class C250, EN 1433 Standard.  
 Boltless locking system, 8 fixing points per lm.  
 Bolt-locking system alternative.  
 30x10 in size high water absorption mesh for protecting heels and walking sticks.  
 Water catching surface: 669 cm<sup>2</sup>/lm.



ARCHITECTURAL SOLUTIONS



Tel.: +34 943 78 06 00  
[info@ulmaarchitectural.com](mailto:info@ulmaarchitectural.com)  
[ulmaarchitectural.com](http://ulmaarchitectural.com)

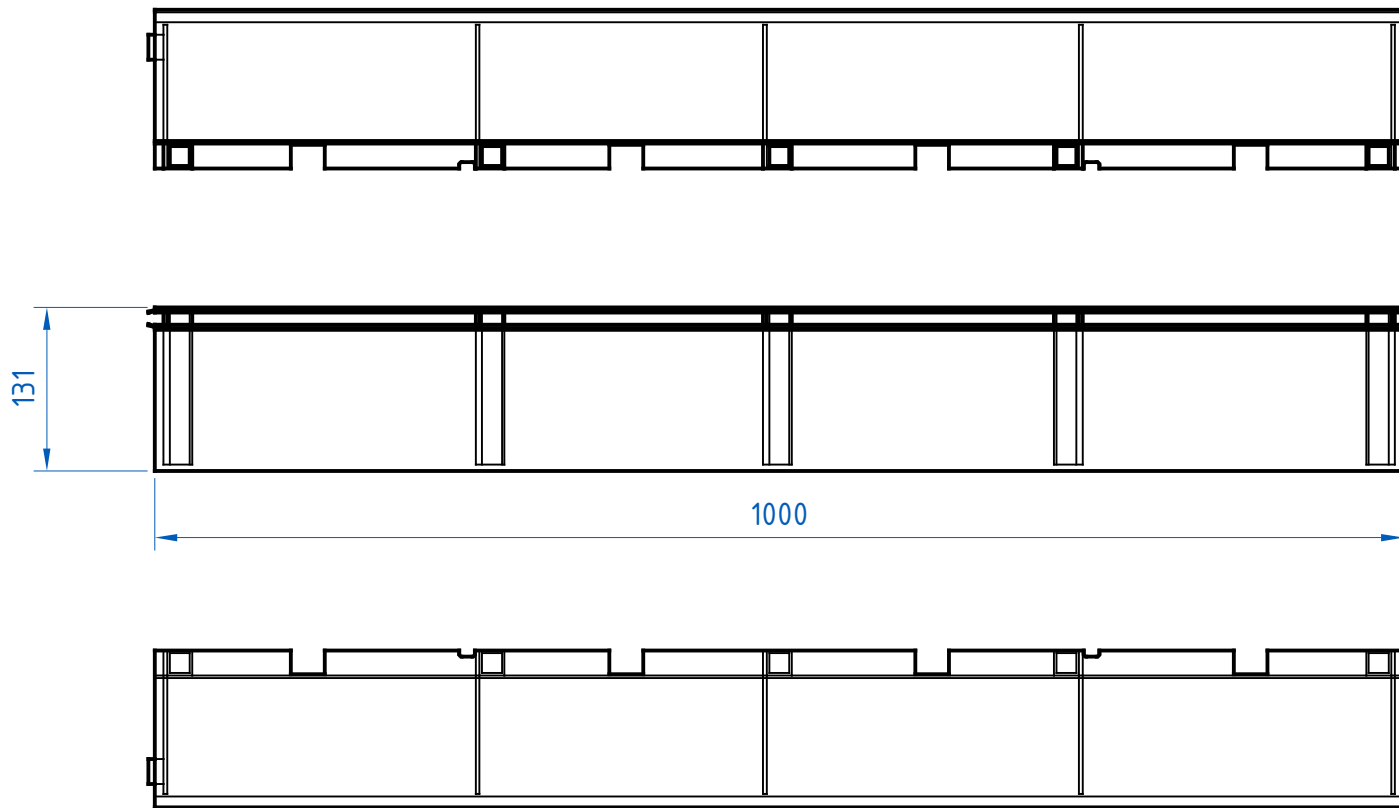
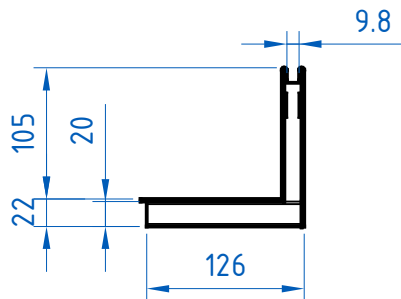

Review: 2018-04

ULMA Architectural Solutions reserves the right to modify the specifications of any of its products without prior notice.

Information about the shown products is only indicative and is based on the existing technical features at the time of issuing.

In the event of any discrepancy in the translation of this document into different languages, the Spanish version will be used.

Latest version in [www.ulmaarchitectural.com](http://www.ulmaarchitectural.com)

For more details, see technical sheets and installation guide.

**Description**

Single slot linear grating for underground installation, with a minimum visual impact reference GRL100ROD. L-shaped galvanized steel grating to use over polymer concrete channels.

Load class up to D400, EN 1433 Standard.

Water catching surface: 98 cm<sup>2</sup>/lm.



ARCHITECTURAL SOLUTIONS



Tel.: +34 943 78 06 00  
 info@ulmaarchitectural.com  
 ulmaarchitectural.com

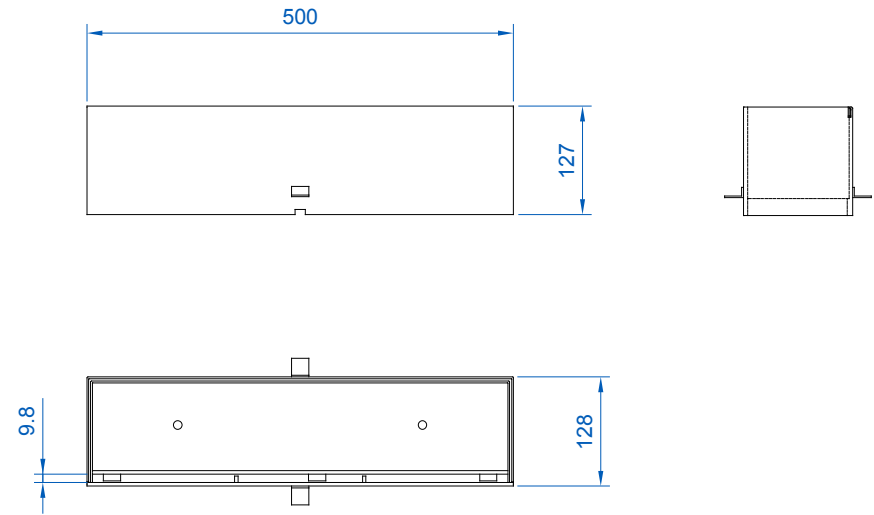
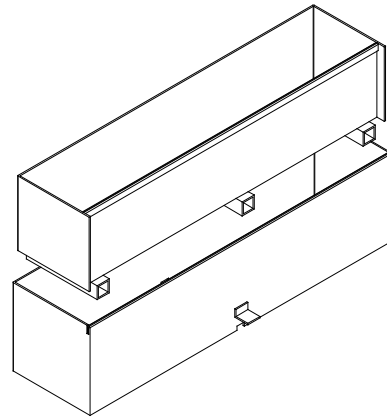
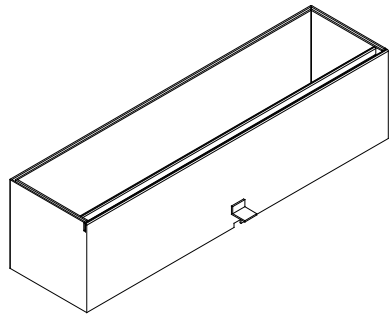

Review: 2018-04

ULMA Architectural Solutions reserves the right to modify the specifications of any of its products without prior notice.

Information about the shown products is only indicative and is based on the existing technical features at the time of issuing.

In the event of any discrepancy in the translation of this document into different languages, the Spanish version will be used.

Latest version in [www.ulmaarchitectural.com](http://www.ulmaarchitectural.com)

For more details, see technical sheets and installation guide.

**Description**

Single slot linear grating set for underground installation, with a minimum visual impact reference GRL100RODMA.

L-shaped galvanized steel grating to use over polymer concrete channels.

Load class up to D400, EN 1433 Standard.

Water catching surface: 98 cm<sup>2</sup>/lm.



ARCHITECTURAL SOLUTIONS



Tel.: +34 943 78 06 00  
 info@ulmaarchitectural.com  
 ulmaarchitectural.com

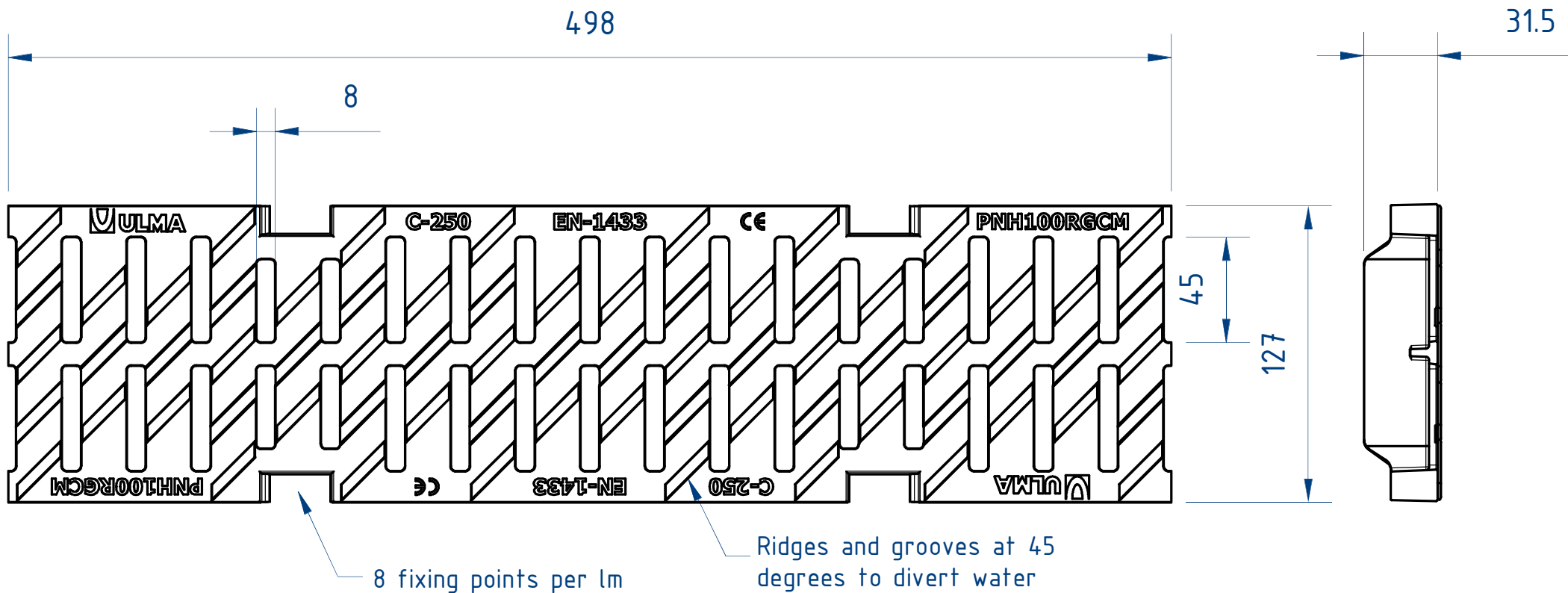

Review: 2018-04

ULMA Architectural Solutions reserves the right to modify the specifications of any of its products without prior notice.

Information about the shown products is only indicative and is based on the existing technical features at the time of issuing.

In the event of any discrepancy in the translation of this document into different languages, the Spanish version will be used.

Latest version in [www.ulmaarchitectural.com](http://www.ulmaarchitectural.com)

For more details, see technical sheets and installation guide.

### Description

Non-slip slotted composite grating reference PNHX100RGCM.

Casted espheroidal graphite ductile iron, EN 1563 Standard. Load class C250, EN 1433 Standard.

Boltless locking system, 8 locking points per lm.

Bolt-locking system alternative.

Ridges and grooves at 45 degrees to divert water.

Walking stick and heel-safe slots.

Water catching surface: 267 cm<sup>2</sup>/lm.



ARCHITECTURAL SOLUTIONS



Tel.: +34 943 78 06 00  
[info@ulmaarchitectural.com](mailto:info@ulmaarchitectural.com)  
[ulmaarchitectural.com](http://ulmaarchitectural.com)